

Operating Instructions
Bedieningsinstructies
Manuel d'utilisation
Bedienungsanleitung
Instrucciones de funcionamiento
Istruzioni per l'uso

DS150/DS250



Welcome to Marcris

The information in this manual referring to specification, design, equipment, materials and external appearance relates to the time at which this manual was printed. Whilst every effort is made to ensure its accuracy, the information in this manual is not binding and is subject to alteration

Year of manufacture 2009

CONTENTS

ENGLISH	14
DEUTSCH	30
ESPAÑOL	47
FRANÇAIS	64
ITALIANO	81
NEDERLANDS	98

Congratulations

You have chosen Marcris for your diamond drilling system. We thank you for your choice and confidence!

Marcris has the sole ambition to lead in diamond technology and quality. The Result is outstanding quality for the professional tradesman.

Marcris is accepted worldwide as a technology leader in diamonds. Marcris diamond tools are used by professional tradesmen who value performance, safety and the lowest possible drilling costs.

The best diamond drilling machine is only as good as the cores which are being used. The machine cannot drill if the cores don't drill!

When choosing diamond cores always consider the cost per hole rather than just the lowest purchase price.

A better core may cost a little more but it will invariably last much longer (up to 20 times) and drills at least twice as fast and does not damage the machine!

Because of this, better cores result in costing you between 10–20 times less than cheap cores.

Marcris International Ltd

Product Management

A

DS150

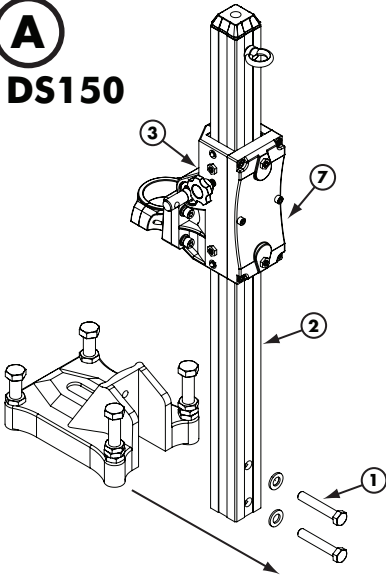

B

DS150

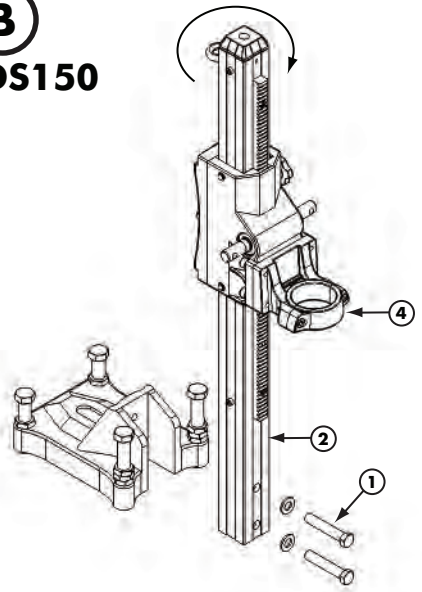

C

DS150

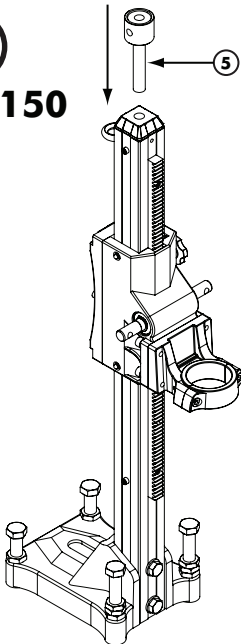

D

DS150

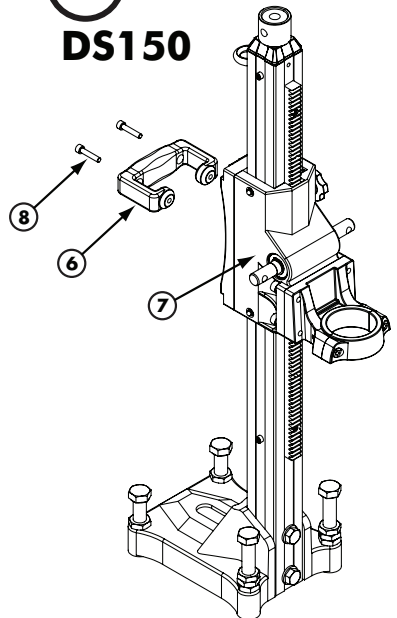

E

DS150

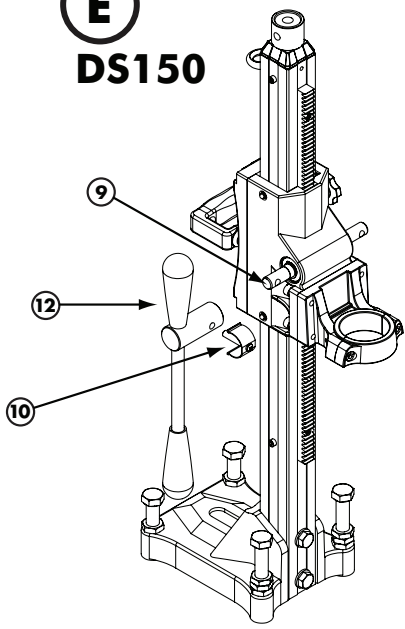

F

DS150

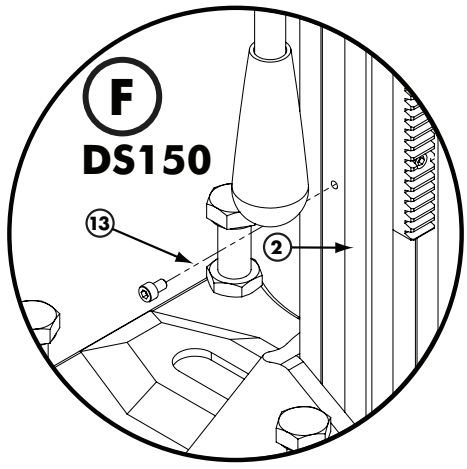

G

DS150

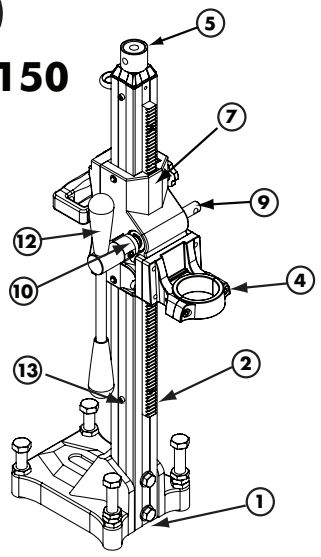

G

DS150

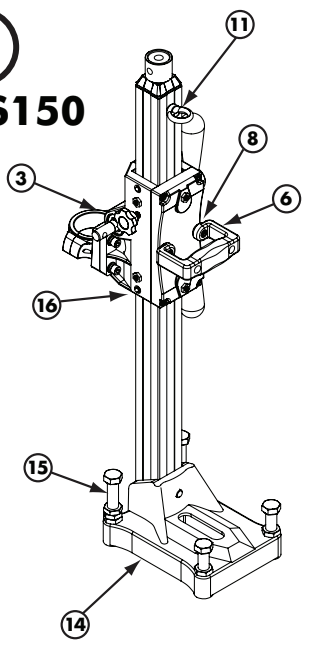

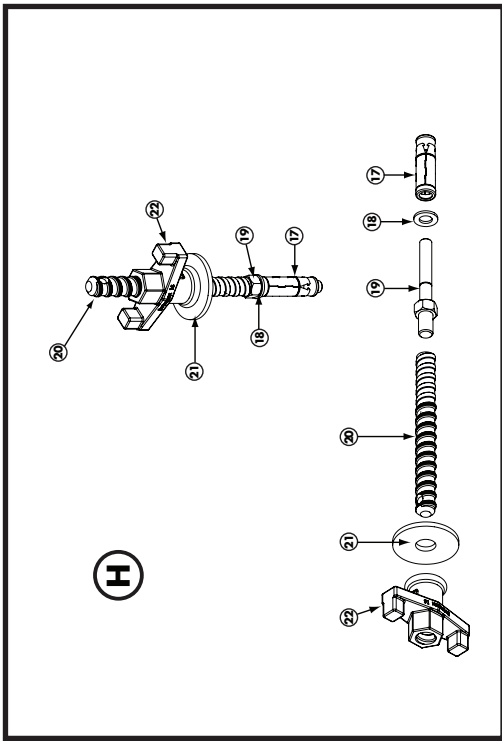

I

DS150

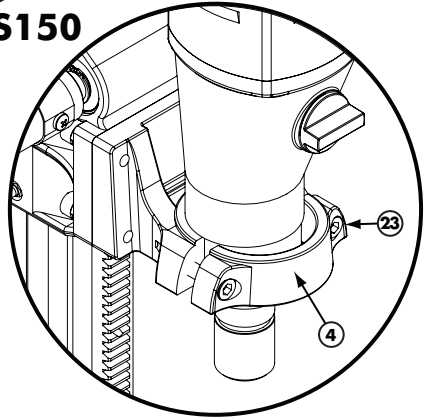

J

DS150

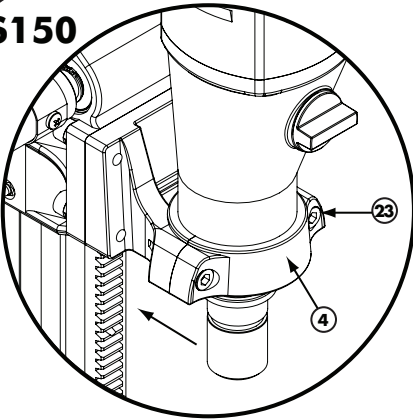

K

DS250

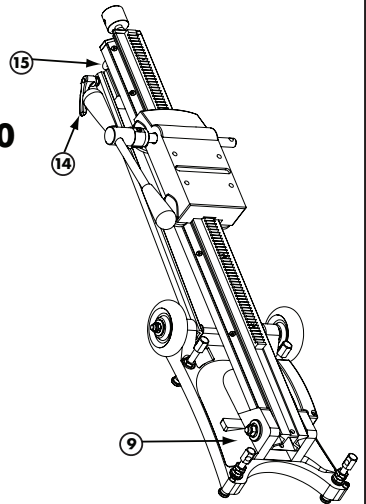

L

DS250

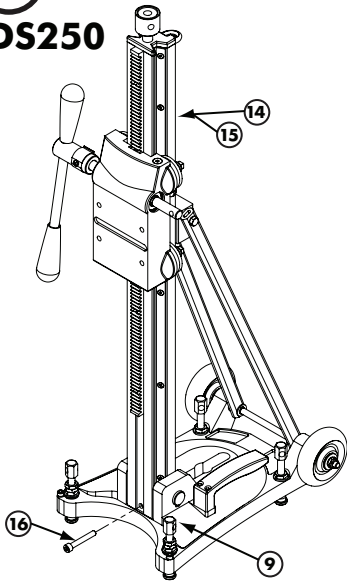

M

DS250

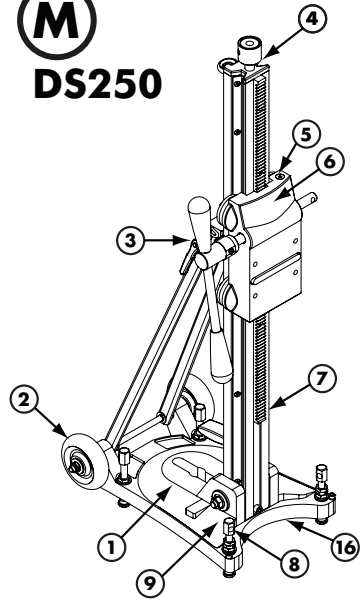

M

DS250

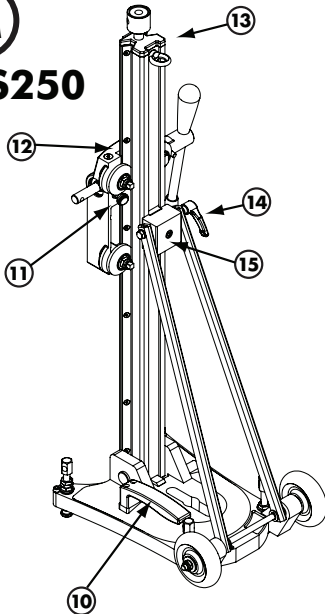

N

DS250

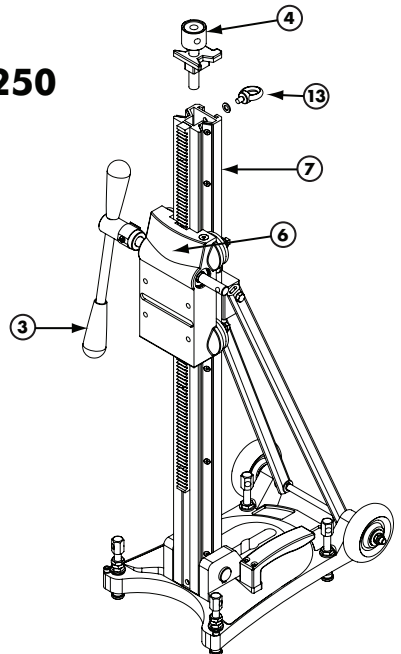

P DS250

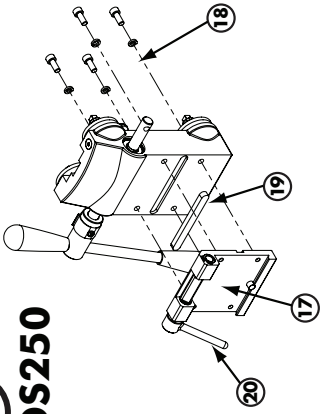

Q DS250

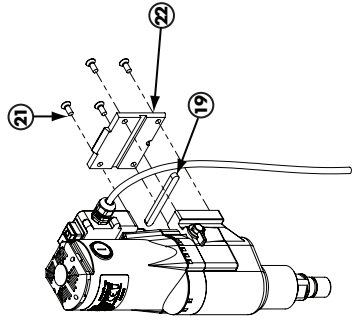

Q1 DS250

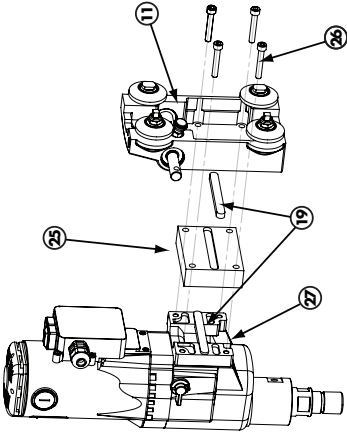

R DS250

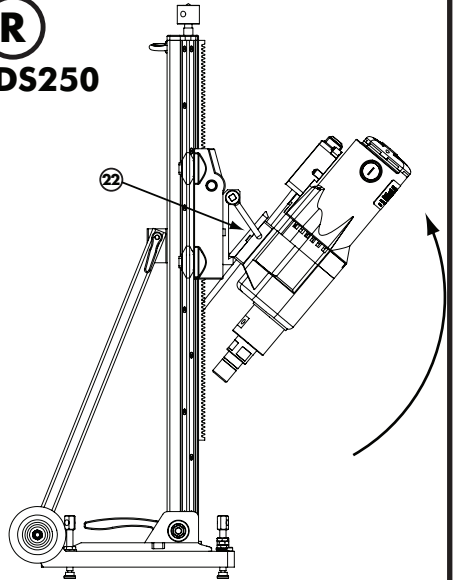

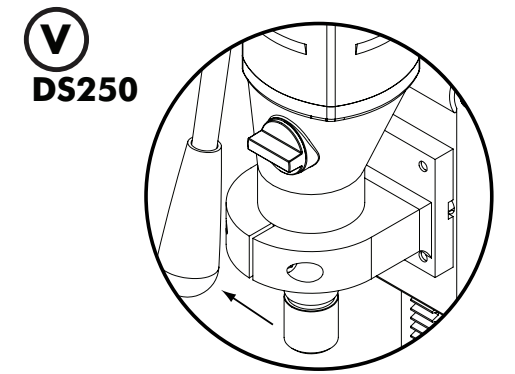
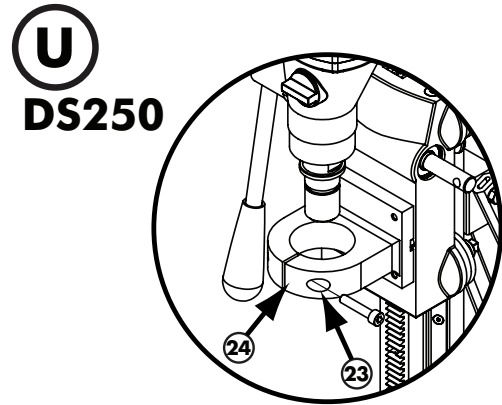
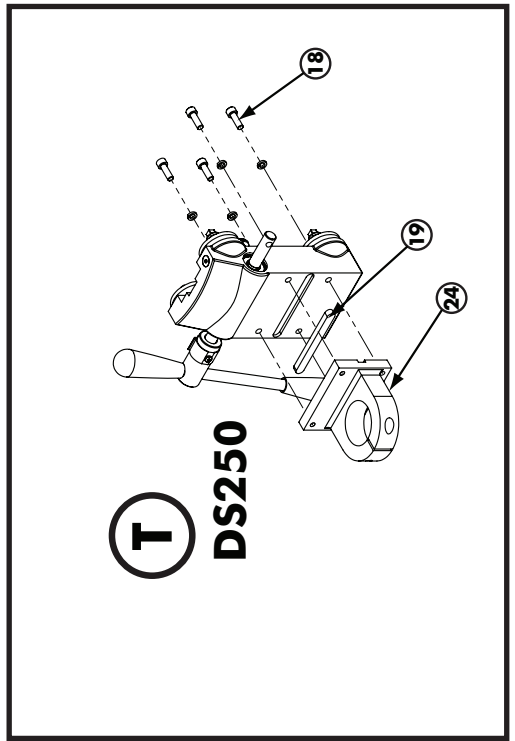
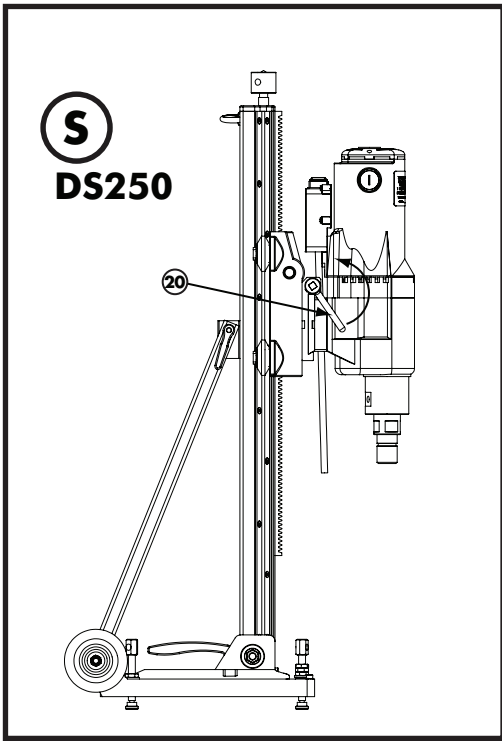

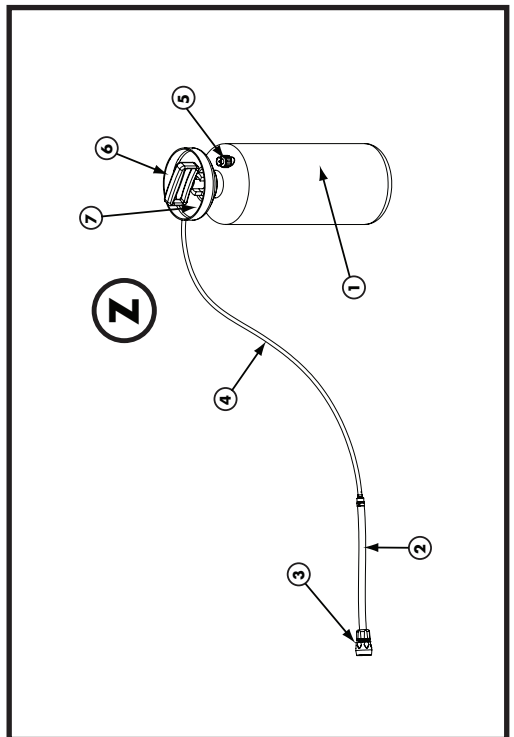
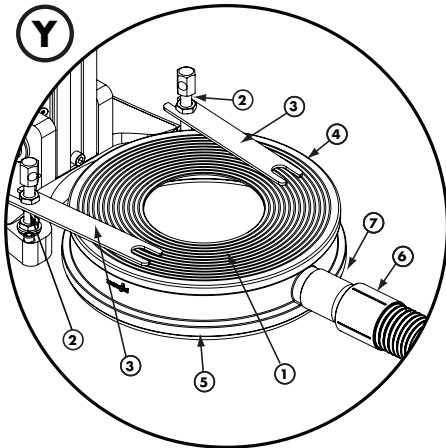
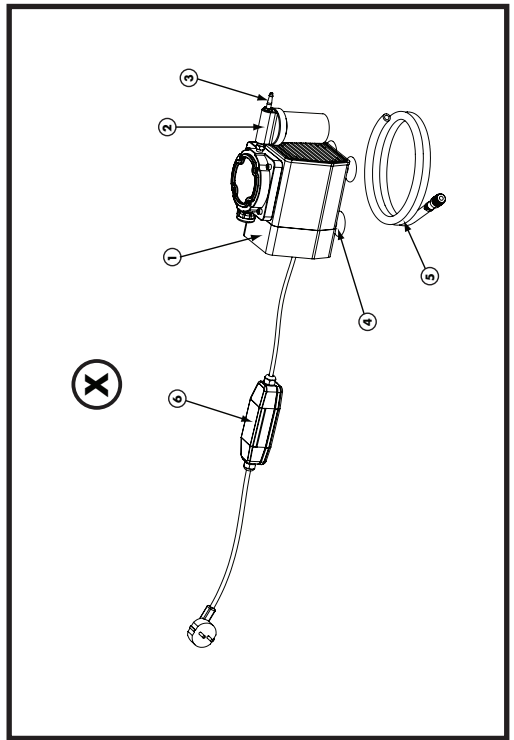
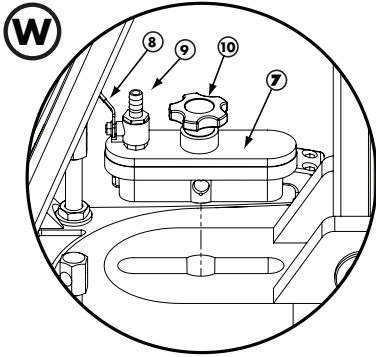



DS150 Spare Parts

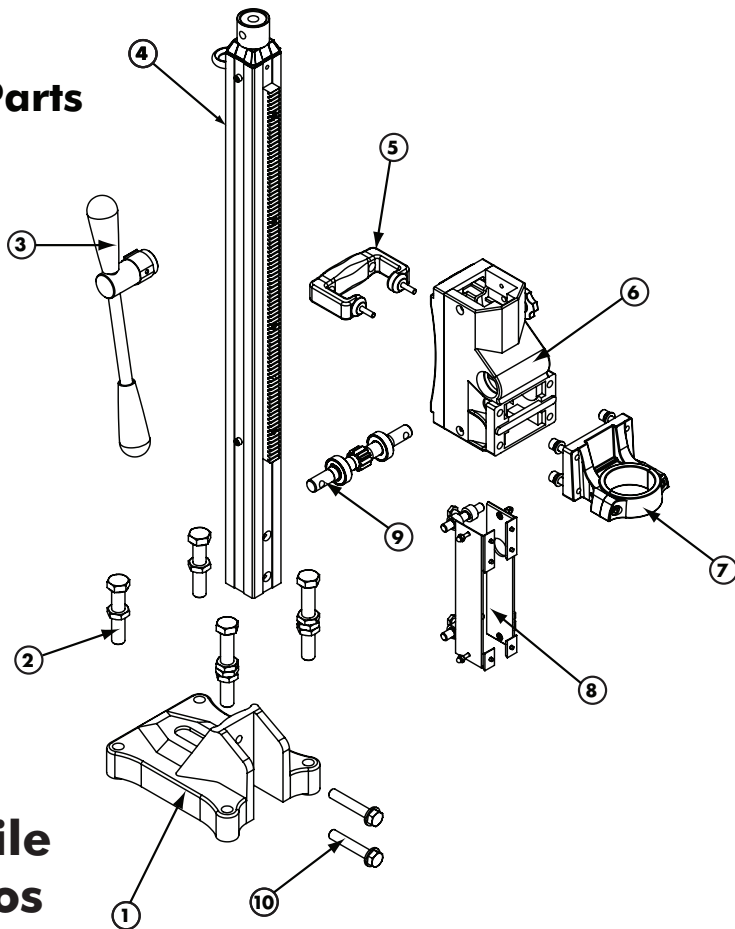

Ersatzteile
Repuestos
Pièces de rechange
Parti di ricambio
Reserveonderdelen



DS250 Spare Parts

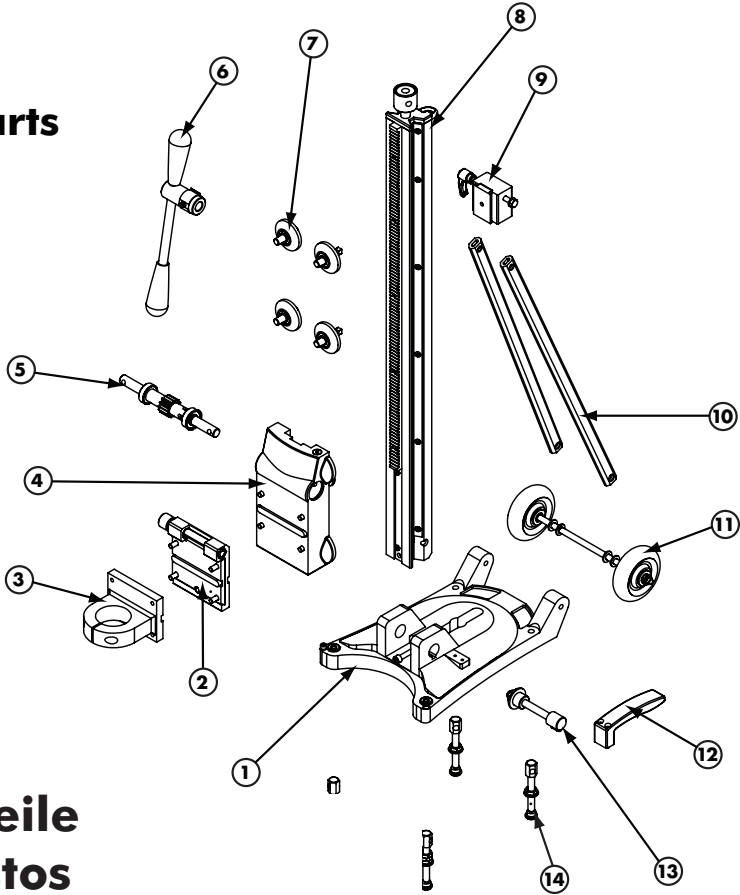

Ersatzteile
Repuestos
Pièces de rechange
Parti di ricambio
Reserveonderdelen

Spare Parts List

DS150 (Fig. AA)

Item	Description	
1	Stand base	7800.300.001
2	Jacking feet (x4)	7800.300.002
3	Crank handle	7800.200.006
4	Stand column	7800.300.004
5	Carry handle	7800.300.005
6	Carriage	7800.300.006
7	Motor clamp DDM3	7800.300.007
8	Carriage guide kit	7800.300.008
9	Drive gear shaft assembly	7800.300.009
10	Column bolt (x2)	7800.300.010

DS250 (Fig.BB)

Item	Description	
1	Stand base	7800.200.001
2	DDM4 Motor quick connect	7800.200.002
3	DDM3 Motor mount	7800.200.003
4	Carriage	7800.200.004
5	Drive gear shaft assembly	7800.200.005
6	Crank handle	7800.200.006
7	Carriage guide kit	7800.200.007
8	Stand column	7800.200.008
9	Rear stay bracket	7800.200.009
10	Tie bars (x2)	7800.200.010
11	Rear wheel assembly (x2)	7800.200.011
12	Carry handle	7800.200.012
13	Column pivot bolt	7800.200.013
14	Jacking feet (x4)	7800.200.014

Registration

Register your machine or drill stand within 28 days for its lifetime warranty and 5 years free servicing* (with service vouchers, which you receive free with every Marcris 850X diamond core drill).

How To Register

To activate the lifetime warranty and 5 years free servicing register your machine or drill stand by mail or via internet . Registration only takes a few minutes. It will save you lots of money.

By Mail

With the enclosed form and envelope.

Internet

www.marcris.com/registration.

Guarantee

30 DAYS MONEY BACK GUARANTEE

If you are not completely satisfied with the performance of your machine or drill stand, simply return it within 30 days, in its original packaging, which is suitable for resale and fit for purpose, to your Marcris distributor, for a full refund.

Proof of purchase must be produced.

LIFETIME MANUFACTURERS WARRANTY

If your machine or drill stand becomes defective due to faulty materials or workmanship, we guarantee to replace all defective parts free of charge or, at our discretion, replace the unit free of charge provided that:

- Proof of purchase is produced and the product has been registered.
- The defect is not due to normal wear and tear.
- The product has not been misused and has been serviced regularly.
- Professional quality consumables, capable of drilling hard materials, have been used exclusively.
- Repairs have not been attempted by unauthorised persons.

Marcris 5 YEAR FREE MAINTENANCE AND REPAIRS*

Your machine or drill stand has been designed to operate for a long period of time with a minimum of maintenance.

Guarantee

Continuous satisfactory and safe operation depends however, upon proper care and maintenance.

Regularly, at least every 18 months ** take the machine or drill stand to your Marcris distributor for inspection which includes:

Machines

- Check up / cleaning
- Clutch re-setting
- Bearing changes
- Seal replacements
- Electrical safety test

Drill Stands

- Check up / cleaning
- Check operation & guide assembly
- Replace worn parts on guide system

With every Marcris 850X core purchased you receive a free service voucher. Collect vouchers and, together with the machine or drill stand needing service and your proof of purchase, hand them to your Marcris distributor. Your distributor will send the machine and vouchers to Marcris.

All you have to do is to pay the postage.

If the machine or drill stand was beyond repair, Marcris would, in return for the vouchers, even give you a replacement machine or drill stand, completely free!

If a machine or drill stand needing service and repair is returned without vouchers, all work and postage will be chargeable at the industry standard rate for power tool repairs.

If you have insufficient vouchers, the repair costs will be reduced as a % of your vouchers. i.e. DDM2 with 5 vouchers would equal 50% off the cost of repairs.

This guarantee is offered as an extra benefit and is in addition to the consumer's statutory rights.

* With the free service vouchers, Marcris will, within 5 years from the date of purchase, carry out the service completely free at no charge. All costs for each service and for any parts are covered by the vouchers!

**For your safety the machines & drill stands must be serviced every time you have collected the appropriate amount of vouchers (meaning you will have very extensively used the machine) or, at 18 month intervals. The guarantee may, at the sole discretion of Marcris, become null and void, if the machine or drill stand is not serviced every appropriate number of cores or within 18 months (whichever is the soonest).

Number of vouchers needed for FREE repair, service, safety check, including all parts and labour:

- DDM2 – 10 vouchers
- DDM3 – 15 vouchers
- DDM4 – 20 vouchers
- DS150 – 5 vouchers
- DS250 – 7 vouchers

DS150 & DS250 Drilling Stands - Safety Warnings & Information

Operational Safety



Observe the safety regulations in the instruction manual of the power tool to be connected to this Drilling Stand.

Read the following safety instructions before attempting to operate these drilling stands.

Save all warnings and instructions for future reference



Safety warning



Always wear safety glasses, dust mask & ear protection



Always wear safety shoes



Always wear safety gloves

- When drilling, at all times, care must be taken.
- Keep work area clean and well lit
- Make sure that everybody who works with the DS150 or DS250 gets properly instructed how to use them safely prior to use.
- Assess the work area and employ measures to minimise any risks to you or other persons.
- Inspect the drilling stand before every use. Do not use if there are any defective parts.
- Make sure not to cut through electric mains, gas or water pipes. Use detection systems prior to drilling.
- Make sure all core drills & accessories are fitted correctly as per manufacturers instructions.
- Never drill from a position where you are not in full control. Make sure to stand on a stable surface.
- If drilling above chest height, work platforms should be used.
- Never drill from a ladder.
- Always ensure you are working safely and within current legislation and regulations.
- Try to avoid continuous operation and consider a break once in a while. Stop working immediately if you notice a tingle in your hands.

Above points are to be observed at any time. Failing to comply may result in serious damage or endanger your health. If there are any questions or queries, please contact your dealer.

DS150 Using Instructions

Your DS150 Drilling Stand has been designed so it can be used with Marcris diamond drills, cores & drilling accessories. It has been designed to accommodate the Marcris DDM2/3 diamond drilling machine for wet diamond drilling into masonry materials such as brick, breeze block, engineering brick, stone, concrete, & reinforced concrete with wet diamond core bits & a water supply.

The stand enables set up in both vertical & horizontal applications

Contents

- DS150 Drilling Stand
- Toolkit containing Allen Keys, spanners, key, PVC tool pouch
- Instruction manual



Prior to assembly or adjustment of DDM2/3 to the DS150 drill stand always unplug the tool

Initial set up of DS150

The DS150 is delivered flat and needs to be assembled safely before use. The carriage is mounted the wrong way around for safe transportation and needs to be reversed for correct set up.

- Ensure carriage locking screw (3) is tightened to secure carriage (7). (Fig A)
- Unscrew column fixing bolts (1) & slide out the drill stand column (2) (Fig. A)
- Turn the column (2) around by 180° so that the motor clamp (4) is facing outwards from the drill stand (Fig B)
- Screw in column fixing bolts (1) to secure column to base (Fig. B)
- Screw in top jacking screw (5) into column (2). (Fig C)
- Fix transport handle (6) to carriage (7) by means of the screws provided (8) (Fig D)
- Slide crank handle (12) onto gear shaft (9) on desired side of working. (Fig E)
- Fix the clip (10) around the gear shaft (9). Ensuring holes are lined up to enable clip to be secured by the pin. (Fig E)
- Remove the transit screw (13) from the column (2). (Fig F)



Ensure carriage is locked at all times when not in use

Illustrated description of functions

The main functions of DS150 drilling stand are illustrated in Fig G

Item	Description	
1	Column fixing bolts	9 Gear shaft
2	Column	10 Crank assembly clip with pin
3	Carriage locking screw	11 Eye bolt
4	Motor clamp	12 Crank assembly feed handle
5	Top jacking screw	13 Transit screw
6	Transport handle	14 Base
7	Carriage	15 Jacking feet
8	Transport handle screws	16 Carriage guide adjusters
		23 Motor clamp screws

Operating Instructions



Follow all safety instruction and observe any relevant regulations. Also refer to DDM2/3 manual for operation of the machine.

Work piece and working area



Always ensure that materials to be drilled are securely supported and stable and will not move during operation. Ensure that the core drill selected is suitable for the material being drilled.

Be aware of the location of pipe work, wiring, fixture and fittings.



Ensure the DDM2/3 mounted on the DS150 drilling stand is fixed securely to the material being drilled by means of an Anchor Kit available from Marcris (part number 7800.001.001)

Assembly & operation by using an Anchor Set (Fig H)

- An Anchor set is required to secure the stand to masonry & concrete surfaces
- Locate the DS150 stand to the desired position and mark the location of the mounting hole on the surface.
- Drill a $\varnothing 16$ mm hole at least 70mm deep. Clean out the dust and debris from the hole
- Insert the shield anchor (17) into the hole. Tap with a mallet to secure.
- Position the small washer (18) on the thread of the setting stud adaptor thread (19)
- Tighten the setting stud adaptor thread (19) into the shield anchor (17) with a spanner until the stud & small washer are secure.
- Screw in the spindle bolt (20) into the setting stud adaptor thread (19) until tight.
- Position the DS150 stand over the anchor
- Place the large washer (21) and spindle wingnut (22) over the spindle bolt (20) and securely tighten the spindle wingnut (22) until secure

Operating Instructions

Item Description

17 Shield anchor	20 Spindle bolt
18 Small washer	21 Large washer
19 Setting stud adaptor thread	22 Spindle wingnut

Connection of DDM2/3 to DS150 drilling stand & Operation (Fig. I, J)

- Ensure that the drill & stand are stable before drilling. Slight adjustments can be made by turning the screws on the adjustable jacking feet (15)
- Mark the area where the hole is to be drilled
- Remove side handle from DDM2/3 by loosening the wing nut (see drawing in DDM2/3 manual)
- Fasten the DDM2/3 to the DS150 drill stand by loosening screws (23) on motor clamp (4)
- Place DDM2/3 vertically into motor clamp until desired position is achieved & is stable
- Tighten screws (23) on motor clamp (4) till DDM2/3 is secure
- Adjust carriage locking screw (3) to allow movement of carriage
- Adjust carriage guide adjusters (16) to desired level of friction
- Plug in machine into the appropriate power supply
- Test correct operation of RCD unit before use (See DDM2/3 -230 manual)
- Disconnect power. For core drills with 1/2" BSP thread, screw 1/2" BSP adaptor into drill spindle
- Screw core drill with 1/2" BSP thread onto adaptor
- For core drills with 1 1/4" UNC thread, screw directly into drill spindle
- To operate the machine depress the trigger
- For continuous operation depress the trigger lock button on handle while trigger is operated
- Slowly feed the core drill into the workpiece using the feed handle of the DS150 (12)
- At the start of the drilling, apply light pressure to allow the core drill to mark a hole
- Apply only gentle pressure during operation. Excessive force may damage the machine or accessories and could result in a shortening of tool life.
- Continue drilling until hole is drilled
- Take extra care when the core drill is about to break through the surface to prevent splintering
- To stop drilling depress trigger.
- When drilling is completed. Disconnect power. Remove cores & accessories from DDM2/3 using spanners.
- Loosen DDM2/3 from Motor clamp (4) by untightening the screws (23)
- Remove Drilling Machine safely from the drilling stand

DS250 Using Instructions

Your DS250 Drilling Stand has been designed so it can be used with Marcris diamond drills, cores & drilling accessories. It has been designed to accommodate the Marcris DDM2/3/4 diamond drilling machine for wet diamond drilling into masonry materials such as brick, breeze block, engineering brick, stone, concrete, & reinforced concrete with wet diamond core bits & a water supply. This should be by means of a Quick Release Precision Mount (part number 7800.200.002) or the enclosed motor fixing plate for the DDM4, or a precision motor mount for the DDM2/3 (part number 7800.200.003) both available separately from Marcris.

The stand enables set up in both vertical & horizontal applications & also is tiltable to enable angled drilling from 0-90°

Contents

- DS250 Drilling Stand
- Toolkit containing Allen Keys, spanners, key, PVC tool pouch, fixing screws
- Motor fixing plate DDM4
- Instruction manual



Prior to assembly or adjustment of DDM2/3/4 to the DS250 drill stand always unplug the tool

Initial set up of DS250

The DS250 is delivered flat and needs to be assembled safely before use.

- Loosen column pivot bolt (9) (Fig. K)
- Loosen rear stay bracket socket screw (15) & quick release handle (14) (Fig K)
- Raise column until vertical (Fig L)
- Secure column by inserting & tightening carriage socket screw (16) (Fig L)
- Tighten column pivot bolt (9), rear stay bracket socket screw (15) & quick release handle (14) (Fig L)

DS250 Using Instructions

Fixing the Quick Release Motor Mount to the DS250 Drill Stand.(Fig N,P,Q)

- Remove eye bolt (13) from drill stand column (7)
- Remove top jacking screw assembly (4)
- Unlock carriage by pulling & twisting carriage lock knob at the back (11)
- Raise carriage (6) on column (7) by turning crank handle (3) until it reaches the top. Remove carriage (6) from column (7) (Fig N).
- Fix the Quick Release Motor mount (17) to the carriage by locating the key bar (19) into the carriage & by using the 4 socket head screws (18) Tighten with an Allen key (Fig P).
- Fix the flat base plate component (22) of the Motor Mount to the base of the DDM4-230 by locating the key bar (19) & by using the 4 countersunk screws (21) (Fig Q).

- Replace the carriage (6) with the motor mount (17) back on the column (7) replacing the top jacking screw assembly (4) & eye bolt (13).
- Use the crank handle (3) to lower the carriage (6) back into position.
- Lock carriage by pushing & twisting carriage lock knob (11)

Fixing the DDM4 to DS250 using Motor Fixing Plate (Fig. Q1)

- Remove carriage (6) from column (7) as above.
- Fix the motor fixing plate (25) to the carriage by locating the key bar (19) into the carriage. Place the 4 fixing screws (26) through the back of the carriage.
- Locate a key bar (19) into the base of the DDM4
- Locate the 4 fixing screws, motor fixing plate and carriage into the base of the DDM4 machine
- Tighten the screws with an Allen key.
- Replace the carriage with the fixed DDM4 back on the column replacing the top jacking screw assembly & eye bolt
- Use the crank handle (3) to lower the carriage & DDM4 (6) back into position.
- Lock carriage & DDM4 by pushing & twisting carriage lock knob (11)

 Always lock the carriage when the assembly is not in use

Illustrated description of functions

The main functions of DS250 drilling stand are illustrated in Fig M

Item Description

1 Base	16 Column socket screw
2 Transport wheels	17 Quick release motor mount DDM4 to DS250
3 Crank assembly	18 Socket head screws
4 Top jacking screw	19 Key bar
5 Level bubble	20 Locking handle
6 Carriage	21 Countersunk screws
7 Column	22 Flat base plate
8 Jacking feet	23 Motor Clamp screws
9 Column pivot bolt	24 DDM3 to DS250 motor mount
10 Carry handle	25 Motor fixing plate DDM4
11 Carriage lock	26 Fixing screws (x4)
12 Carriage guide wheel adjusters	27 DDM4 base
13 Eye bolt	
14 Rear stay quick release handle	
15 Rear stay bracket socket screw	

Connecting DDM4 to DS250 Drilling Stand & Operation (Fig R,S)

- Attach the DDM4 to the motor mount (17) by placing the angled edge of the flat plate (22) fixed on the base of the DDM4 into the groove on the Motor Mount and push the DDM4 forward. Secure in place by turning the handle (20) until it locks.



Always ensure the DDM4 is mounted firmly & securely on the DS250 drill stand to prevent movement.

- Plug in machine into the appropriate power supply
- Test correct operation of RCD unit before use (see DDM4-230 manual)
- Disconnect power. For core drills with 1/2" BSP thread, screw 1/2" BSP adaptor into drill spindle
- Screw core drill with 1/2" " BSP thread onto adaptor
- For core drills with 1 1/4" UNC thread, screw directly into drill spindle
- Whilst holding the feed handle release the carriage lock knob (11)
- To operate the machine depress the start / stop button
- Slowly feed the core drill into the workpiece using the feed handle of the DS250 (3)
- At the start of the drilling, apply light pressure to allow the core drill to mark a hole
- Apply only gentle pressure during operation. Excessive force may damage the machine or accessories and could result in a shortening of tool life.
- Continue drilling until hole is drilled
- Take extra care when the core drill is about to break through the surface to prevent splintering
- To stop drilling depress start / stop button.
- Raise carriage (6) until core is a safe distance clear from workpiece
- Lock the carriage lock by pushing & twisting carriage lock knob (11)
- When drilling is completed. Disconnect power. Remove cores & accessories from DDM4 using spanners.
- Unlock DDM4 from Quick Release Motor Mount by turning the handle (20) to release
- Remove DDM4 safely from the drilling stand
- Keep the Motor Mount on the DS250 for next use. It is not necessary to remove this every time drilling is completed.

Connecting DDM3 to DS250 Drilling Stand. (Fig T, U, V)

The DDM3 Drilling machine can be fitted to the DS250 by means of a special precision motor mount (part number 7800.200.003) available from Marcris.

This can be screwed directly onto the carriage of the DS250 using the screws provided. The carriage will need pre-removing before assembly.

- Remove carriage from column of DS250 as described when fixing DDM4 quick release (Fig N)
- Fix the DDM3 to DS250 motor mount (24) to the carriage (6) by locating the key bar (19) into the carriage & by using the 4 socket head screws (18) Tighten with an Allen key (Fig T)
- Replace the carriage (6) with the motor mount (24) back on the column (7) replacing the top jacking screw assembly (4) & eye bolt (13).
- Use the crank handle (3) to lower the carriage (6) back into position.
- Lock carriage by pushing & twisting carriage lock knob (11)
- Ensure that the drill & stand are stable before drilling. Slight adjustments can be made by turning the screws on the adjustable jacking feet (8)
- Mark the area where the hole is to be drilled
- Remove side handle from DDM2/3 by loosening the wing nut (see drawing in DDM2/3 manual)
- Fasten the DDM2/3 to the DS250 drill stand by loosening screw on motor clamp (23) (Fig U)
- Place DDM2/3 vertically into motor clamp until desired position is achieved & is stable (Fig U)
- Tighten screws (23) on motor clamp (24) till DDM2/3 is secure (Fig V)
- Commence drilling by following DDM2/3 & DS250 operating instructions above
- When drilling is completed. Disconnect power. Remove cores & accessories from DDM2/3 using spanners.
- Loosen DDM2/3 from Motor clamp (24) by untightening the screw (23)
- Remove Drilling Machine safely from the drilling stand

Fixing the DS250 Drilling Stand with a Vacuum Pump. (Fig W,X)

If the stand is mounted to flat delicate surfaces a vacuum pump can be used to secure the stand. The vacuum created in the base keeps the stand securely in position



The surface should be clean & free of debris otherwise suction may drop causing movement of the stand



If the drilling stand is to be fixed by a vacuum grip fixing device then this shall never be used alone for drilling in unstable positions such as on vertical walls and on the ceiling.

- Fit the rubber vacuum seal into underside of the DS250 base
- Place the vacuum plug (7) in the opening on the base of the stand
- Tighten with the plug locking screw (10)
- Position the stand to desired location
- Fasten the hose (5) onto the quick connector fitting on the vacuum pump (3)
- Fasten the other end of the hose to the hose connector on the plug (9)
- Switch on vacuum pump. Keep the pump switched on for as long as required
- Vacuum can be switched on & off via the shut off valve handle (8) on the plug
- Ensure that the drill stand is flat and as close to the surface as possible by adjusting the jacking feet ensuring maximum suction is achieved

Item Description

1 Vacuum pump	7 Vacuum plug
2 Water trap assembly	8 Shut off valve handle
3 Pump hose quick connect	9 Hose connector
4 Foot	10 Plug locking screw
5 Hose assembly 2m. includes quick connect	
6 Plug assembly (230v RCD)	

Water Collection Ring. Using Instructions (Fig Y)

When wet drilling a water collection ring system is recommended to ensure proper discharge of water and safe & clean working conditions.

2 sizes of water collection rings are available from Marcris (\varnothing 150mm & \varnothing 250mm – part numbers 7800.001.004/5). They are supplied with 2 clamp bars to enable them to fit both the DS150 & DS250 drill stands

Water Collection Ring. Using Instructions (Fig Y)

- Select the appropriate size water collection ring for the core being used
- Cut out a hole in the top seal to fit the core being used (1)
- Loosen the 2 front nuts on the drilling stand (2) by a few turns and hold the water collection ring in front of the base over the surface where the hole is to be drilled
- Slide the clamp bars (3) onto the loosened nut. Use the end with the larger groove for the DS150 & the end with the smaller groove for the DS250.
- Rest the other end of the clamp bar on top of the water collection ring (4) to hold it in place.
- Tighten the 2 nuts (2) so the clamp bars (3) are secure
- The water collection ring (4) should be positioned so it rests on the surface & covers the selected area for drilling. Use the bottom seals on the water collection ring to secure in position (5).
- Attach a suitable vacuum hose (6) to the water collection ring outlet (7) so that it holds the ring in place & water collected during drilling is suitably extracted.
- Switch on the power on the vacuum cleaner before commencing drilling.

Item Description

1 Top seal	4 Water collection ring
2 Jacking feet bolts (DS150 & DS250)	5 Bottom seal
3 Clamp bars	6 Vacuum hose
	7 Outlet

Adjusting the drill angle. (DS250 only)

The stand enables set up in both vertical & horizontal applications & also is tiltable to enable angled drilling from 0-90°.

- To drill at an angle remove column socket screw (16) from base of column
- Loosen the rear stay bracket socket screw (15)
- Loosen rear stay quick release handle (14)
- Loosen column pivot bolt (9)
- Tilt the column until the desired angle is achieved
- Tighten the rear stay quick release handle (14)
- Tighten the rear stay bracket socket screw (15) until secure.
- After use return to upright position by reverse procedure

Adjusting the crank handle (Fig E)

The crank handle assembly can be fitted to either the left or right side of the drilling stand.

- Remove the clip (10) fixed around the crank shaft (9)
- Slide off the crank handle
- Move the crank handle (12) to the other side of the drilling stand and slide it onto the crank shaft
- Fix the clip around the crank shaft. Ensuring holes are lined up to enable clip to be secured.

Transportation

Your DS150 comes with a carrying handle (6). (Fig G).

Your DS250 comes with transportation wheels (2) and a carrying handle (10). (Fig M)

Water Pressure Bottle (Fig Z)

When no water supply is readily available a water pressure bottle can be used.

- Twist handle (6) to unscrew pump assembly and lift to remove
- Fill to near the top with water
- Replace handle (6) and twist until tight.
- Connect hose connector (3) to DDM2/3/4 water hose by pushing into place until secure
- Ensure tap on DDM2/3/4 is in the off position
- Unlock pump handle (6) by twisting out of its lock (7)
- Pump pressure into bottle by repeated raising & lowering pumping action on the handle (6)
- When sufficient pressure is in the bottle lock the handle back in position (7).
- The water supply is now ready for starting drilling
- Water flow can be started by turning on the tap on the DDM2/3/4 machine

Item Description

1	Water pressure bottle	5	Pressure relief valve
2	12mm bore hose	6	Pump handle
3	Gardena type hose connector	7	Pump handle lock
4	6mm bore hose		



Also refer to DDM2/3/4 manual

Optional Accessories

Drilling aids and accessories are available from Marcryst. Contact your Marcryst dealer for more information.

Always follow the manufactures guidelines when attaching accessories to the machine.

Technical Data

	DS150	DS250
Height	840 mm	1000 mm
Width	170 mm	270 mm
Weight	9.6 kg	17 kg
Capacity	150 mm	250 mm

Maintenance

Your DS150 & DS250 has been designed to operate over a long period of time with a minimum of maintenance. However it is recommended that they are regularly serviced for continuous satisfactory operation by Marcris. For details of 5 years FREE maintenance and repairs see the front of this booklet.

CE-Declaration of conformity

Marcris declares that the DS150 & DS250 drilling stands have been designed in compliance with 98/37/EC

Recycling



According to WEEE directive 2002/96/EC, old machinery should be returned for recycling or safe disposal when they eventually become to be thrown away (see symbol on nameplate of the drill). Separate collection of used products and packaging allows materials to be recycled and used again. Re-use of recycled materials helps prevent environmental pollution and reduces the demand for raw materials. Ensure that the old tool is returned to Marcris International Ltd and does not end up in unsorted municipal solid waste.



Marcris International Limited
Marcris House
Kirk Sandall Industrial Estate
Doncaster DN3 1QR
England
T: +44 (0)1302 890888
F: +44 (0)1302 883864
E: info@marcris.com
W: www.marcris.com

Marcris Diamantwerkzeuge
Vertriebsgesellschaft mbH
Karl-Benz-Str. 8
79761 Waldshut-Tiengen
Deutschland
T: +49 (0)7741 966 72 0
F: +49 (0)7741 966 72 99
E: info@marcris.de
W: www.marcris.com

Marcris Diamantwerkzeuge GmbH
Postfach 37
5322 Koblenz
Schweiz
T: +41 (0)41 630 25 43
F: +41 (0)41 630 25 63
E: info@marcris.ch
W: www.marcris.com